

Cruzar

(Cruzar can be finished out with Marley or Hardwood)

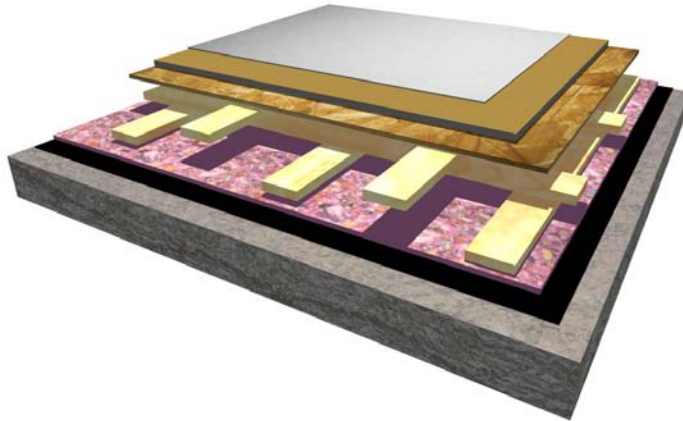

Polyethylene

6 mil POLYETHYLENE Vapor Barrier

½" Shock Absorber

This type of padding is used most often by the floor covering industry. It is made from scraps of the high-density foams used in furniture making that are bonded together. Padding comes in various thickness and densities. The density is rated at so many pounds per cubic foot. For example, a 5 lb pad would weigh 5lb per cubic foot. The CRI (carpet and rug institute) recommends a pad of at least 5lbs, For sub floor installations.

3 layers of 1x4 (2 ¼ inches)

Southern yellow pine 1x4 arranged in three layers running perpendicular to one another. Clear (or low knot) boards are used to insure durability. This portion of the sub floor also uses construction grade adhesive to eliminate squeaking.

2 layers of 1/2" Tongue & Groove Plywood

Two layers of marine grade plywood running either perpendicular or diagonal to one another depending upon the preference of the customer. Tongue and Groove plywood provides the smooth transition between panels.

Cascade By Harlequin

Cascade - the 'ideal' surface for ballet, jazz and contemporary dance, Cascade is suitable for both temporary and permanent installation and is extremely resistant to wear. The surface provides a perfect 'feel' - silky soft without any hint of being slippery.